



Figure # 236

Bronze Threaded Swing Check Valve

Product Features

- 125# WSP / 200# WOG
- Bronze Body
- Threaded Ends
- Swing Check
- "Y" Pattern
- Bronze Disc
- MSS-SP-80
- NSF to 2"



Certified to
ANSI/NSF 61



Materials & Specifications

Item	Description	Material	Specification
1	Body	Bronze	B62-C83600
2	Cap: 1/4" - 2"	Brass	B283-C37700
2	Cap: 2-1/2" - 4"	Bronze	B62-C83600
3	Disc	Brass	B283-C37700
4	Plug	Brass	B16-C36000
5	Hanger Pin	Brass	DR Alloy

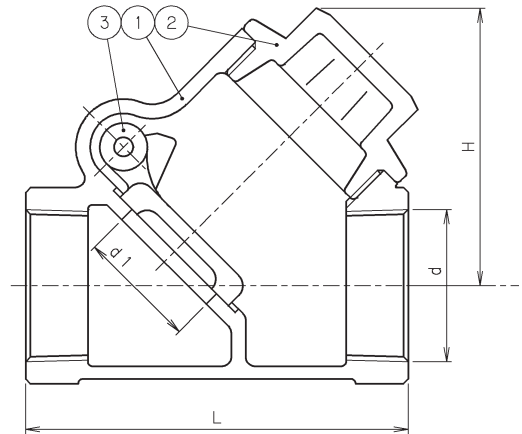

Dimensions & Weights (inches-lbs.)

Size	1/4	3/8	1/2	3/4	1	1-1/4	1-1/2	2	2-1/2	3
d1	.59	.59	.59	.75	.98	1.26	1.50	1.97	2.48	2.99
H	1.64	1.64	1.64	1.95	2.28	2.71	3.17	3.84	4.66	5.47
L	2.21	2.21	2.21	2.76	3.15	3.78	4.33	5.04	6.14	7.24
S	1.10	1.10	1.10	1.34	1.61	1.97	2.24	2.76	3.39	3.94
Cv	1.5	2.8	5	9	20	36	51	92	162	247
Wt.- lbs.	.46	.44	.57	.95	1.34	2.11	3.08	4.99	8.71	12.50

